

# VEGO Dynamic AEM 02

February 2013



# AEM 02 Turntable, T- Controller

## Functions / Setups

- › Turn 90°
- › Inward and outward transfer
- › Bypass

## Additional setups (optionally)

- › Cross mode
- › Sorting function
- › +/- 90° Turn (fix rail change)



 **Flexibility for different  
production concepts**

# Technical Specification

Length	830 mm
Width	830 mm
Height	985 mm
PCB width	50 - 460 mm
PCB length	70 - 460 mm
Transport height	850 mm +/- 50 mm ( 950 mm +/- 50 mm optionally )
Cycle time	+/- 12 Sec. ( 90° turn )

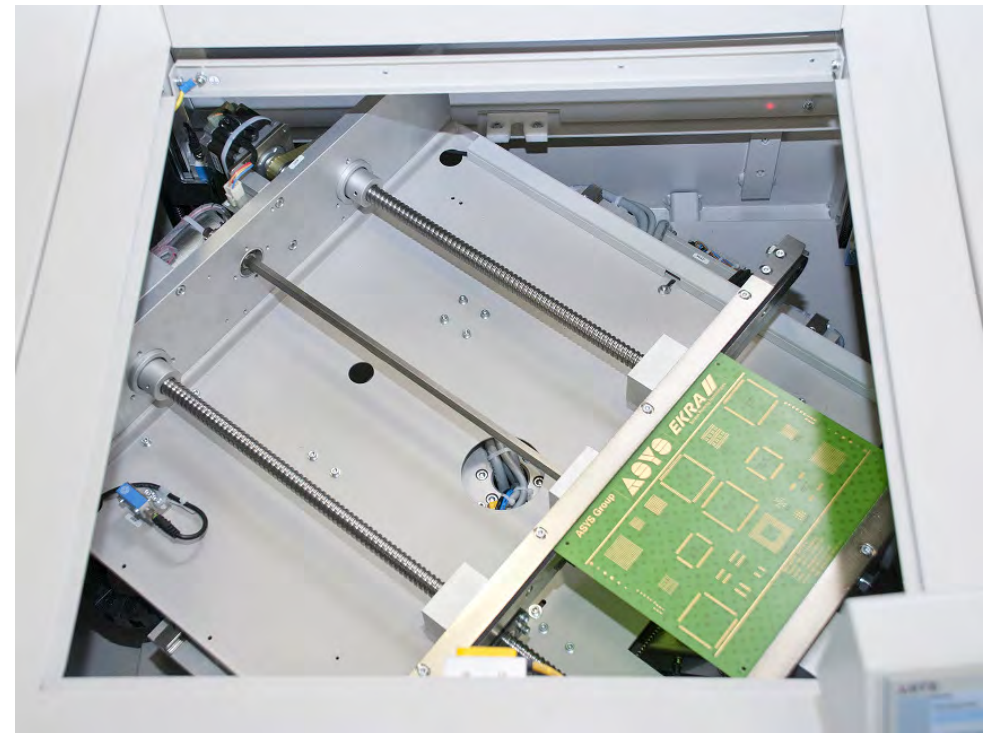

# Process

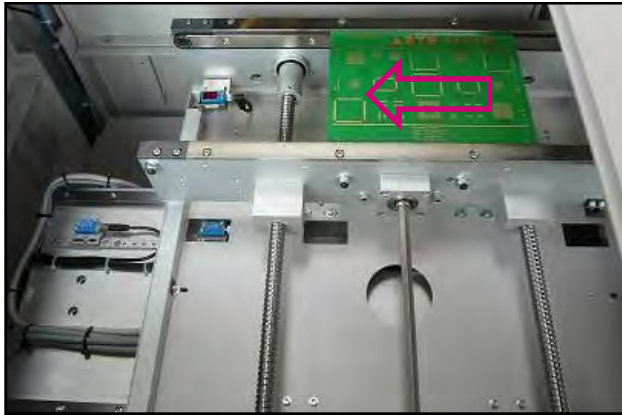

Takeover PCB from n-1  
Linear table in takeover position

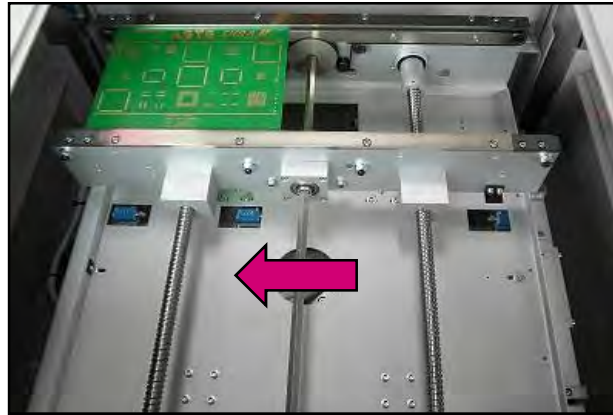

Linear table moves in middle position

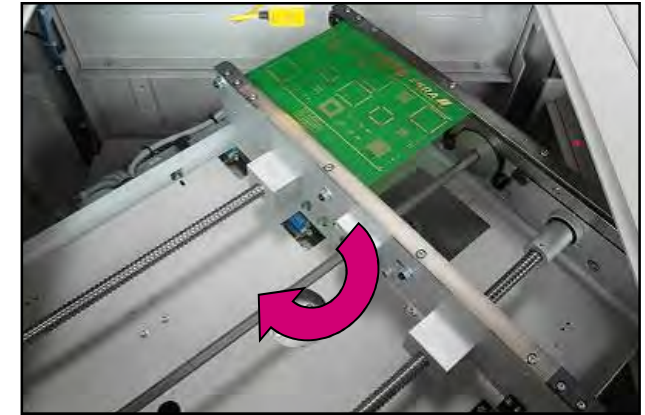
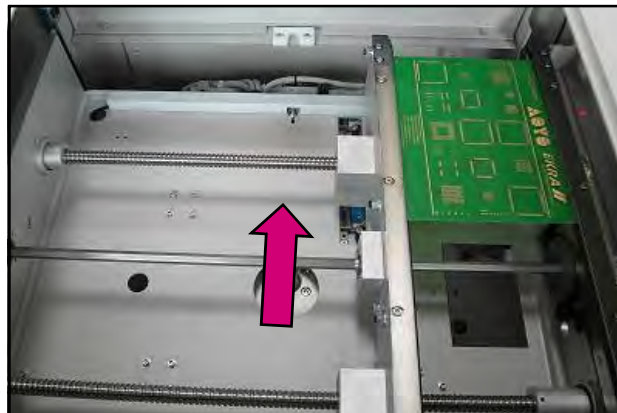
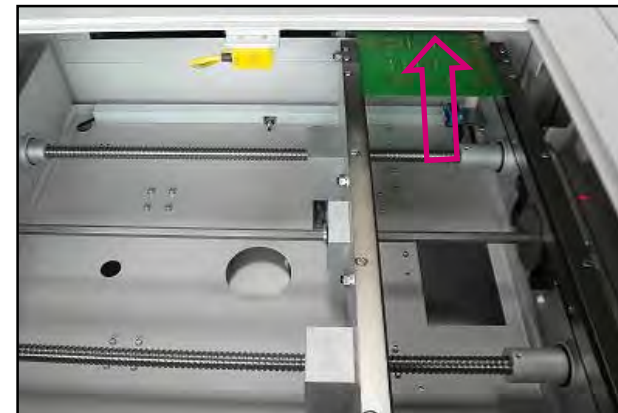

Table turns 90°



Linear table moves in handover position



Handover PCB to n+1  
Linear table in handover position

# Functionality

- › In- / Outlet on all 4 sides possible (optionally)  
Base version are 3 sides

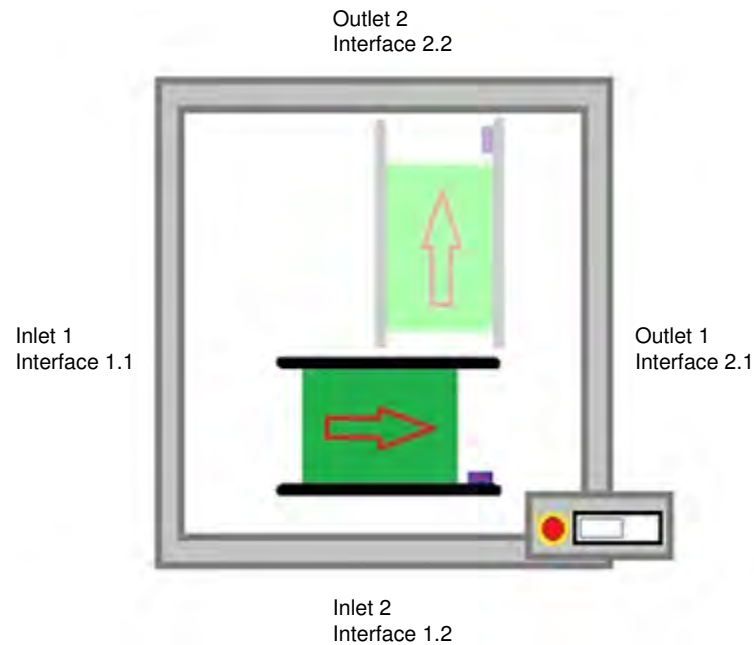

## Operation

- › Rotatably mounted console for operating from 2 sides
- › Operator panel type AOPT350 with graphical color display
- › Changing Parameters and setup new recipes during automatic mode
- › Password protected userlevel (configurable)
- › Product memory function



## Safety

- › Emergency- stop button
- › Hinged cover with contactless safety switch (Interlock)
- › Optionally: Safety- shutter at the takeover positions
- › Optionally: In- / outlet conveyor with safety cover



**Cover closed**



**Cover open**



**Shutter closed**



**Shutter open**

## Width adjustment

- › Width adjustment by clamping lever (Standard feature)
- › Width adjustment by spindles electrically driven (option)
- › Automatic width adjustment by input absolute position at the operator panel (additional option)

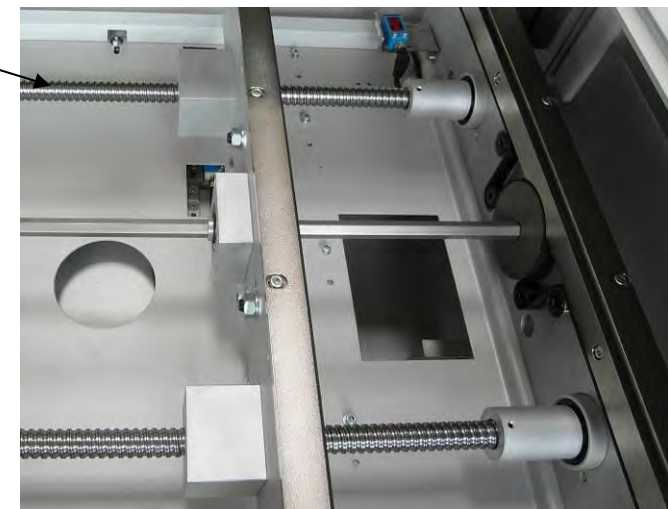
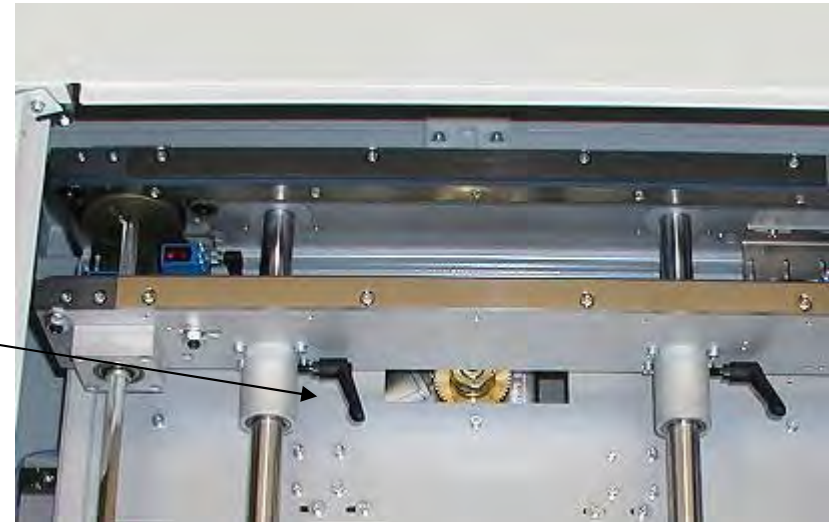



## Frame

- › Robust steel frame
- › Completely ESD powder coated

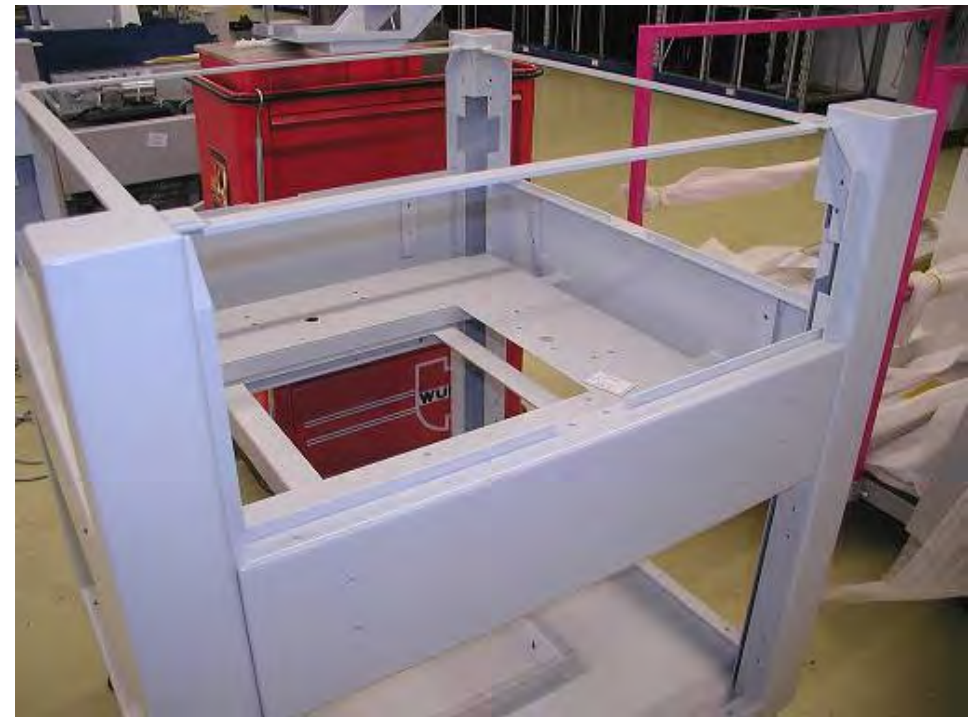

## Mechanic

- › Mechanical structure made of solid aluminium
- › High quality and durable mechanic parts



## Electric

- › Electrical cabinet with flap door with double-bit lock
- › Main switch usable as emergency stop
- › 2x ASYS AMI- interface module for 2 In-/ outlet interfaces ( SMEMA or SIEMENS connectable) icluded



**Electrical cabinet**



**AMI interface modules**

## Drives

- › Servo drives for linear- and turn movement controlled via CAN-bus system
- › Soft and fast movements protect the material and allows shortest cycle times

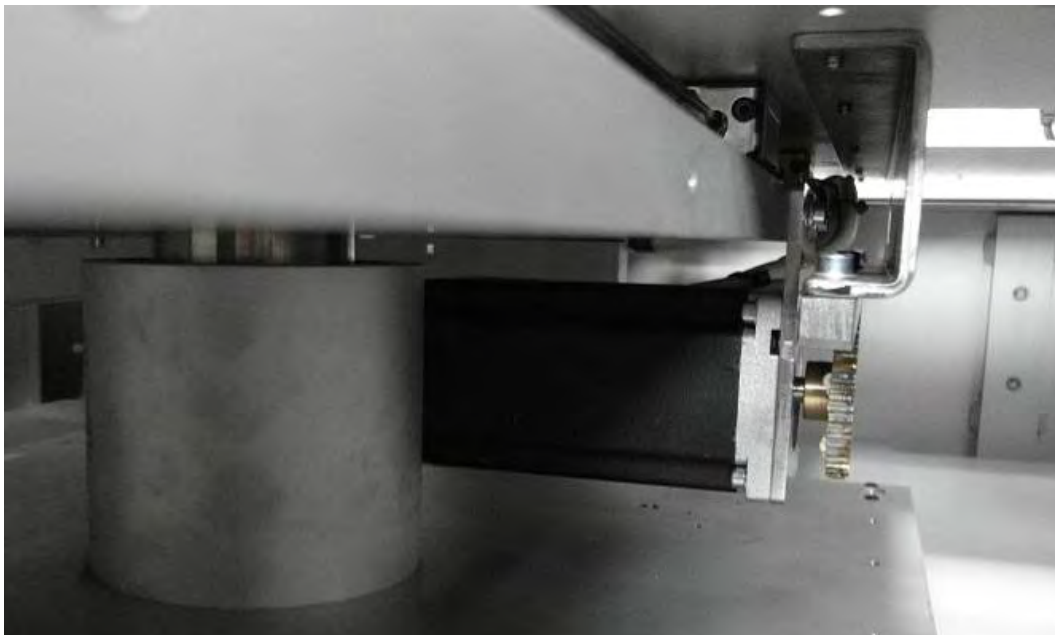

**Servo drive of the linear table**



**Drive pulley of the turn table with cable bushing**

## Sensing

- › High- quality photoelectric proximity switch with „multiline“ light beam for safe detection of PCB's with holes or cutouts
- › Additional sensors for “gap control”

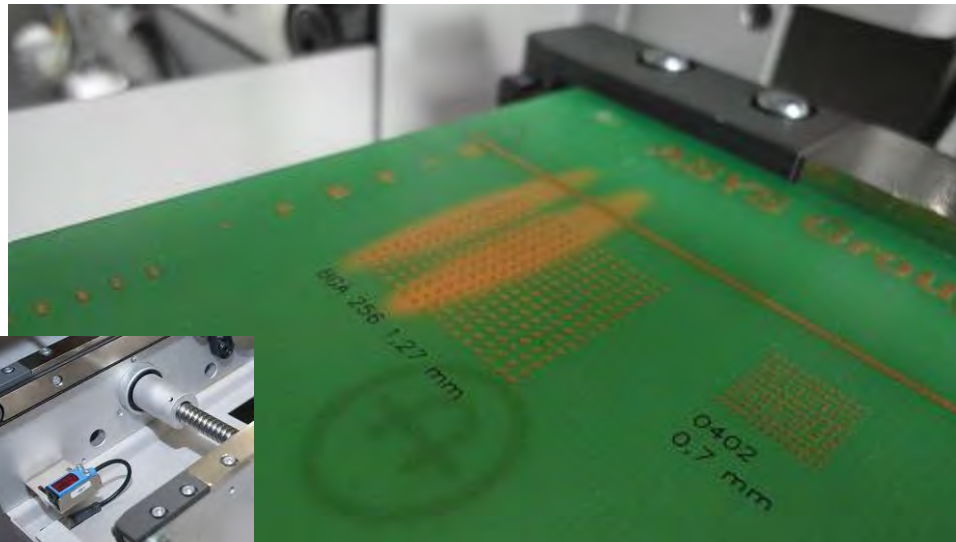

**PCB detection**



**Gap control sensor**



## Option: In-/ outlet conveyer

- › Mounting option up to 4 conveyors
- › In- / outlet conveyor controlled by main machine



## Option: Magazine lift

- › Lift table (folding) for 1 magazine
- › Optionally:  
For line unloading (magazine loading)  
For line loading (magazine unloading)
- › 2 lift tables possible (Loading and Unloading)



Pusher + puller in combination

