

## VEGO TRM 01-04



### Description

TRM transport modules are used to buffer or transfer PCBs between process machines. The strong steel tube frame is particularly robust and consists of an integrated control cabinet and a table construction to support the conveyor.

The PCB is taken over from the upstream system and handed over to the downstream system. The PCB transfer can be SMEMA compliant, or optionally in a synchronous mode for improved cycle time. All modules are also available in dual-lane and flexible dual-lane versions.

### Features

- \_ Color display with graphical user interface
- \_ Product parameters can be changed during running operation
- \_ Product memory function
- \_ Different segment lengths possible
- \_ Frame cut-out for optional integrated ergonomic workstation (only for machines 1000 mm or longer)
- \_ Preparation for optional foot-rest and lamp assembly are included in the standard design.
- \_ Inlet can be disabled (for purging the conveyor or for manual PCB insertion)

### Options

- \_ Transport height 950mm +/- 50mm
- \_ Electric width adjust
- \_ Automatic width adjust
- \_ Inspection function 0-99 with display  
Inspection frequency and current counter reading.  
Configurable inspection segment. Inspection period can be limited with timeout
- \_ Adjustable speed
- \_ Hinged ESD cover
- \_ Hinged Safety ESD cover with interlock for disabling of upstream/downstream systems
- \_ PCB weight up to 6kg
- \_ Workstation upgrade
- \_ Pin lift mechanism including good/bad sorting function
- \_ Upgrade for thin PCBs (< 0.7mm)

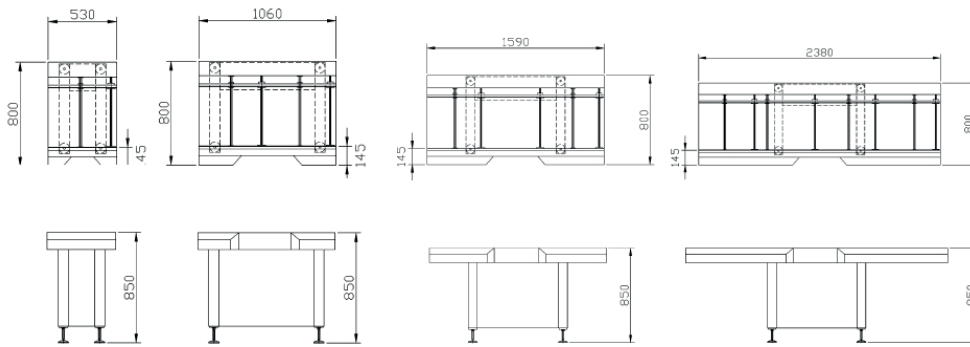

## VEGO TRM 01-04

	Type 1	Type 2	Type 3	Type 4
<b>Machine Configuration</b>				
Transport height	850 mm ± 50 mm <sup>a)</sup>			
Max. transport width	<b>460 mm</b>			
Interface	SMEMA, Siemens			
Transfer direction	Left to right / right to left			
Operating side	Front of the machine			
Fixed rail	Front of the machine			
<b>Panel Dimensions</b>				
Panel length	70 to 460 mm			
Panel width	50 to 460 mm			
Panel thickness	0.8 to 4.5 mm			
Component clearance	± 40 mm			
Panel weight	to 3 kg			
<b>Installation Requirements</b>				
Power supply	230 V / 115 V, 50 / 60 Hz, ± 10%			
Power supply system	L1 + N + PE			
Power consumption	0,2 kW			
<b>Machine Description</b>				
Length x Width x Height <sup>b)</sup>	<b>530</b> x 800 x 850 mm	<b>1060</b> x 800 x 850 mm	<b>1590</b> x 800 x 850 mm	<b>2120</b> x 800 x 850 mm
Netto weight	100 kg	135 kg	170 kg	205 kg
Noise Level	< 75 dB			
<b>Upgrades</b>				
Machine networking via IC Net				

a) Optionally transport height to 950 mm ± 50 mm

b) Other dimensions on request