

VEGO MPS 50D

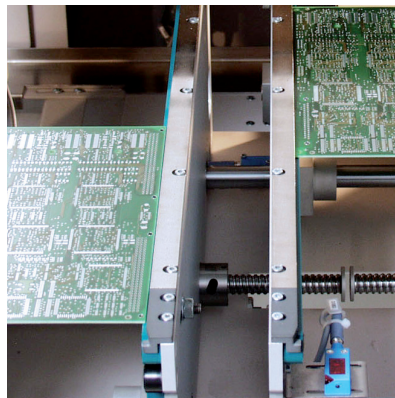

Description

Inline magazine buffer for dual lane. The unit consists of a dual lane inlet-conveyor, two independent lifting axles and a dual lane outlet-conveyor. Both lanes are separately controlled and are working independent from each other. The magazines are swapped separately on both sides of the unit.

Features

- _ Variable operating modes:
 - Pass-through
 - Input transfer
 - Output transfer
 - LIFO
 - FIFO
 - Sorting
 - Cooling
- _ Double track unit
- _ Built in shuttle mechanism
- _ Single lane operation possible

Options

- _ Magazine adaptation
- _ Automatic width adjust
- _ Multiple insertion
- _ Good/bad sorting

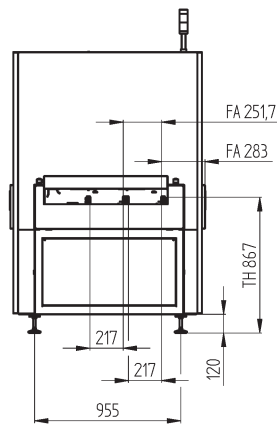
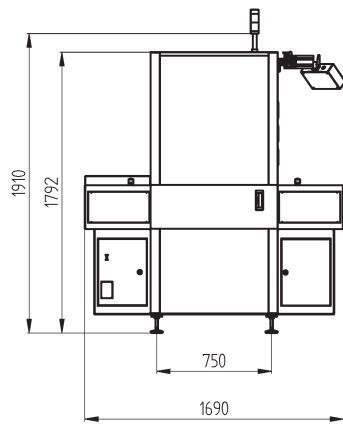

VEGO MPS 50D

Machine Configuration

Transport height	850 mm ± 50 mm
Max. transport width	216 mm
Interface	SMEMA, Siemens
Transfer direction	from left to right
Operating side	Front of the machine
Fixed rail	Front of the machine

Magazine Size

Magazine length	400 mm
Magazine width	320 mm
Magazine height	568 mm
Slot spacing	5 - 20 mm
Buffer spacing	1 - 50 Slots
Single magazine weight	max. 30 kg

Panel Dimensions

Panel length	70 to 370 mm
Panel width	50 to 216 mm
Panel thickness	0.5 to 4.5 mm
Component clearance	+/- 40 mm
Panel weight	max. 3 kg

Installation Requirements

Power supply	230 V / 115 V, 50 / 60 Hz, ± 10%
Power supply system	L1 + N + PE
Power consumption	1,5 kW
Air supply	6 bar
Air consumption	10 NI/min

Machine Description

Length x Width x Height	1280 + magazine length x 1154 x 1770 mm
Netto weight	< 650 kg
Noise level	< 75 dB

Upgrades

Machine networking via IC Net